

Please read the following Instruction
before processing with the further operation

JV3S Series

Supplement for the Basic Operation manual

This manual describes function added after the Operation manual for JV3 series was printed.

[Operation manual P.1-2]

Working environmental temperature

This equipment should be used at 20-35°C to implement a stable print.

[Operation manual P.1-13]

Sizes of the medium that can be used

Plotting width : Printable width will be shorter 40 mm at most when using high-speed mode.

JV3-130S : 1321 mm

JV3-160S : 1570 mm

[Operation manual P.2-12]



- Set the medium so that it does not run off to the right of the pinch roller at the right end.

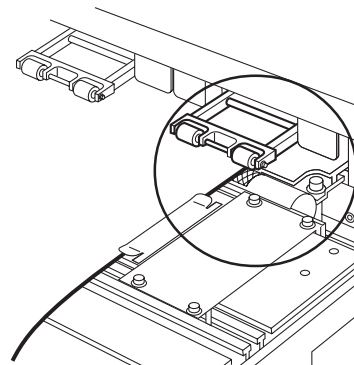

Effective Plotting Area

The device has an area which cannot perform printing, due to mechanical reasons. This area is called “dead space”.

< JV3-130S/160S >

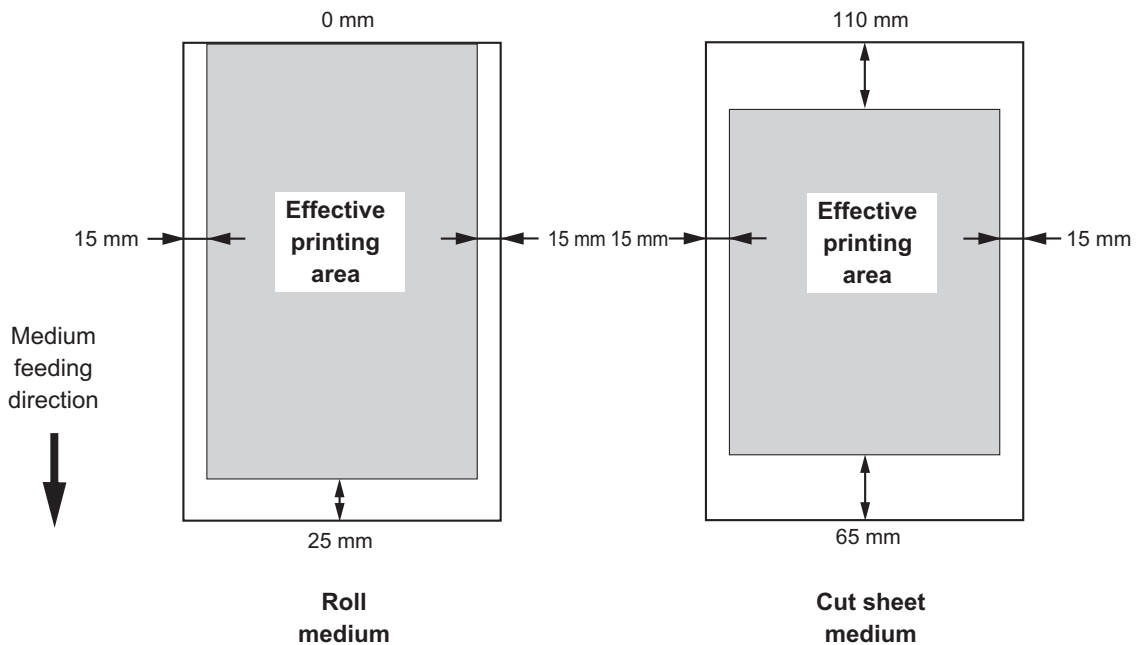

Changing the effective printing area...

Initial value of dead space for right and left of medium is 15 m each. The effective plotting area can be changed by changing the dead space. Dead space is set with [Margin] in FUNCTION mode.

( Operation manual P.4-8)

Establishing An Origin

Establish an origin in terms of data on medium loaded on the device.

In the case of printing with the unspecified origin, set the origin again.

STEP

1. After the medium detection is completed, move the carriage to the position at which to establish an origin by pushing the JOG keys [▲], [▼], [◀] and [▶].

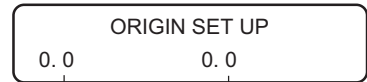

Origin(Length) Origin(Width)

2. After deciding the origin, push the [ENTER] key.

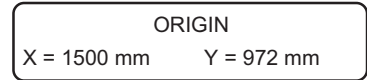

The effective plotting area is displayed on the LCD, and the device enters the LOCAL mode.

(When a roll medium is used, X is not detected.)

When the device starts plotting the next time, it uses the origin that has been established unless the origin is changed.

Initial value of origin

The printing origin is set like right chart when shipping.

The value of scanning direction (X') can be changed with [Margin] in FUNCTION mode.

 Operation manual P.4-8)

